

THE BEST MACHINE
FOR DEMANDING JOBS

SABER[®]

PAPER CUTTERS



The Power of a SABER®

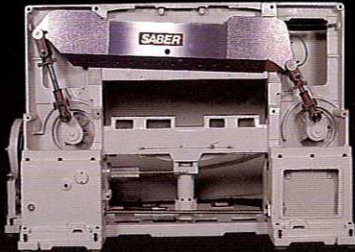

For taking on heavy-duty cutting projects, it doesn't get better than the SABER: the best technology, the most power, the greatest endurance. Set up this workhorse and you'll have nothing but years of satisfying, easy, high-quality operation. Cut the biggest jobs down to size in no time—again and again. The SABER makes it simple.

Mechanical Excellence

Manufactured to ISO 9001 standards, the SABER X-15 features the strongest and most precise mechanical design on the market. Its massive knife bar cuts through piles with pressure applied equally at both sides, ensuring greater cutting power, less pile disturbance, less mechanical wear, and extended knife life. The centrally located hydraulic clamp cylinder provides steady, uniform clamping pressure. A ball-bearing lead screw, linear guides, and the SABER's patented DC drive system control the backgauge's precision, providing smooth and accurate positioning at all speeds.



World-Class Control

The SABER X-15 features a wide format, color touch screen that details an extensive array of easy-to-use programming and control options. With only a few keystrokes, operators can save and quickly recall both operator preferences and the details of every job. The computer control system designed by C&P Microsystems comes CIP3/4-enabled and network compatible as standard.

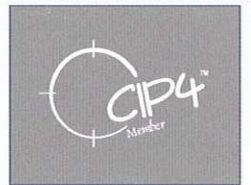

No Cuts on Safety

No corners have been cut to ensure operator and machine safety on the SABER X-15, which complies with CE requirements. Two-hand cut release; safety latching of the knife bar; two-stage hydraulics; and a computer-controlled IR safety curtain—all standard. Two independent circuits monitor all major functions on the SABER X-15.



CUT FAST, CUT WELL, AND CUT SAFELY WITH A SABER

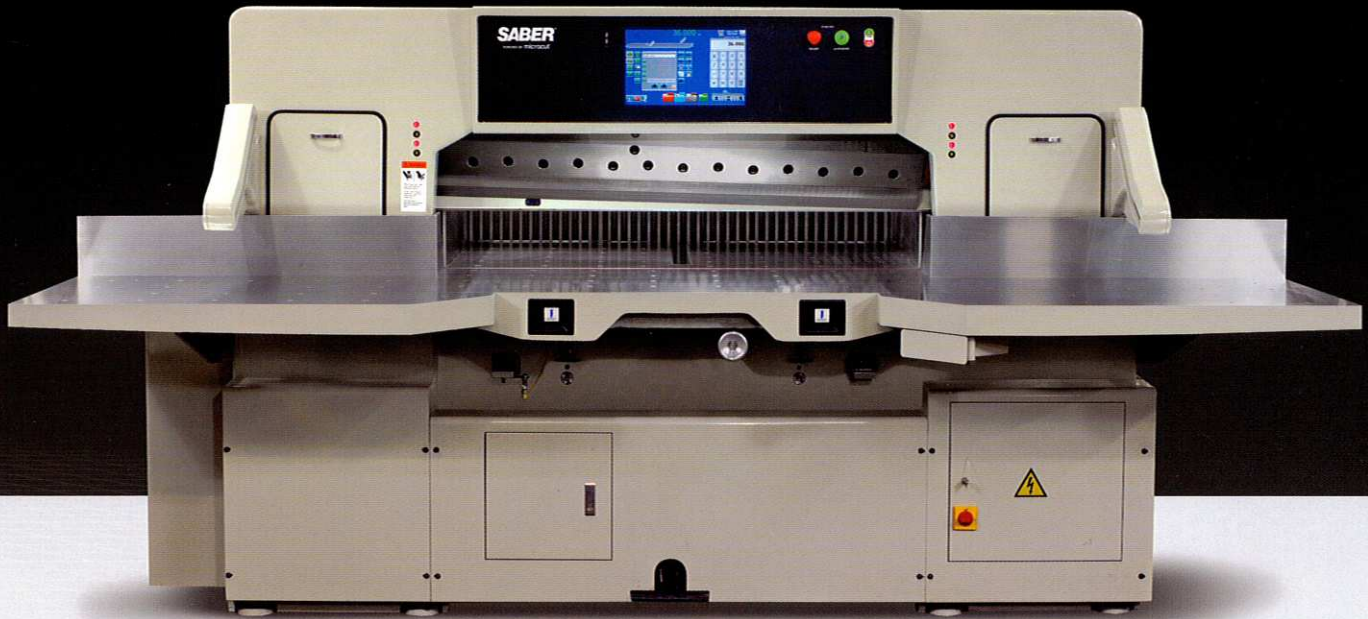

Why is a SABER X-15 the best paper cutter on the market?

- 1. Heavy Duty Construction**
Provides stability and longevity
- 2. Double Arm Pull Knife Drive**
More powerful, precise cutting
- 3. Center Actuated Clamp**
Insures uniform pressure regardless of pile position
- 4. 15" Color Touch Screen**
microcut® computer control with intuitive graphic interface makes programming fast and easy (12" screen on 37"(95cm) model)
- 5. CIP 3 / 4 Capable with Networking**
No extra hardware or software required
- 6. Automatic Knife Adjustment (Patent pending)**
Knife setting and adjustment can be done automatically without tools (not available on 37"(95cm) model)
- 7. Programmable Clamp Pressure**
Automatically adjusts clamp pressure as needed
- 8. Ball Bearing Lead Screw with Linear Guides**
Guarantees precise backgauge positioning
- 9. Cast-Iron Side Tables**
Provide strength and durability with no interference from legs
- 10. Chromed Main and Side Tables**
No maintenance required

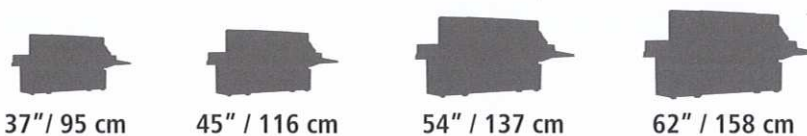

37" / 95 cm

45" / 116 cm

54" / 137 cm

62" / 158 cm

SABER X-15 comes in four cutting sizes

SABER[®]
PAPER CUTTERS

SABER X-15 Specifications & Technical Data

Model	37"	95 cm	45"	116 cm	54"	137 cm	62"	158 cm
Max. pile height without false clamp	6"	15 cm	6.5"	16.5 cm	6.5"	16 cm	6.5"	16.5 cm
Max. cutting width	37"	95 cm	45"	116 cm	54"	137 cm	62"	158 cm
Max cutting depth	38"	98 cm	45"	116 cm	58"	148 cm	65"	165 cm
Min. cut with false clamp on	2.5"	6.3 cm	3"	7.5 cm	3"	7.5 cm	3"	7.5 cm
Min. cut without false clamp	0.8"	2.0 cm	1.3"	3.3 cm	1.3"	3.3 cm	1.3"	3.3 cm
Working depth front table	26"	67 cm	28"	71 cm	28"	71 cm	29"	75 cm
Table height	35"	90 cm	37.5"	95 cm	37.5"	95 cm	37.5"	95 cm
Overall machine width	97"	246 cm	108"	275 cm	116"	295 cm	140"	354 cm
Overall machine length	91"	231 cm	100"	254 cm	118"	300 cm	142"	360 cm
Overall machine height	61"	155 cm	66"	168 cm	66"	168 cm	69"	175 cm
Passage opening table disassembled	36"	91 cm	40"	103 cm	45"	115 cm	50"	127 cm
Grinding reserve on knife	1.2"	3 cm	2.5"	6 cm	2.5"	6 cm	2.5"	6 cm
Min. clamp pressure (pedal)		none		none		none		none
Max. clamp pressure	8800lb	4000 kg	9900 lb	4500 kg	10,150 lb	4600 kg	13,200 lb	6000 kg
Knife thickness	.50"	12 mm	.54"	13 mm	.54"	13 mm	.54"	13 mm
Backgauge speed	16"/sec	40 cm / sec	16"/sec	40 cm / sec	16"/sec	40 cm / sec	16"/sec	40 cm / sec
Net weight with full oil tank	7040 lb	3200 kg	10100 lb	4600 kg	11400 lb	5200 kg	13200 lb	6000 kg
Gross weight (seaworthy crating)	7400 lb	3400 kg	11000 lb	5000 kg	12500 lb	5700 kg	14500 lb	6600 kg
Power	220/380 VAC 50/60hz							

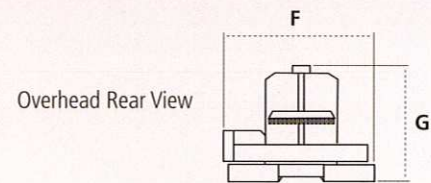
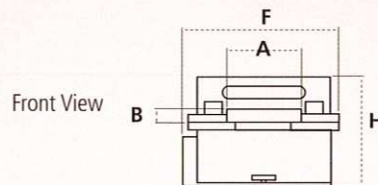
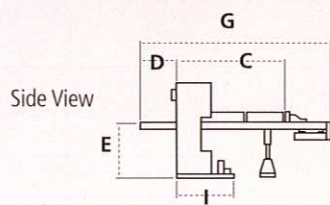

Dimensions

Model	37"	95 cm	45"	116 cm	54"	137 cm	62"	158 cm
A. Max. cutting width	37"	95 cm	45"	116 cm	54"	137 cm	62"	158 cm
B. Pile height without false clamp	6"	15 cm	6"	16 cm	6.5"	16.5 cm	6.5"	16.5 cm
C. Max. working depth rear table	38"	98 cm	45"	116 cm	58"	148 cm	65"	165 cm
D. Working depth front table	26"	67 cm	28"	71 cm	28"	71 cm	28"	71 cm
E. Table height	35"	90 cm	37.5"	95 cm	37.5"	95 cm	37.5"	95 cm
F. Overall machine width	97"	246 cm	108"	275 cm	116"	295 cm	140"	354 cm
G. Overall machine length	91"	231 cm	100"	254 cm	118"	300 cm	142"	360 cm
H. Overall machine height	61"	155 cm	66"	168 cm	66"	168 cm	70"	168 cm