

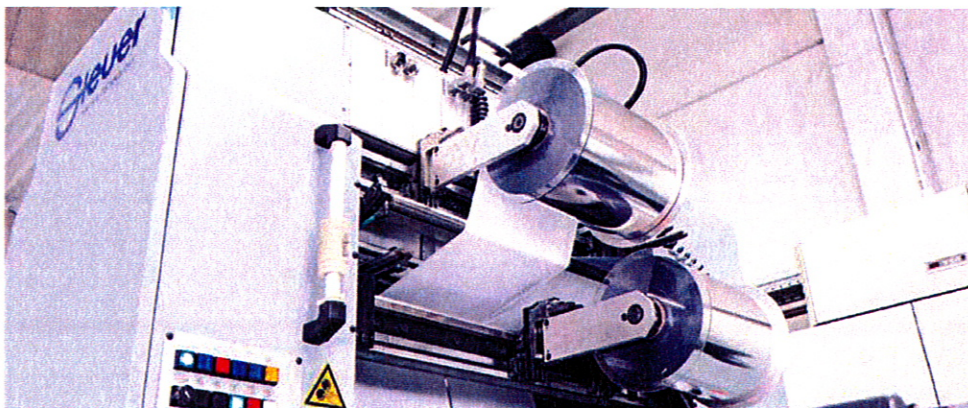

Steuer Foil-Jet FBR 2020

FBR 2020 – the concept for new performance parameters and production stability

FBR 2020 – with this concept you ensure the future of your Foil-Jet FBR by upgrading a new software and hardware control.



[Description](#) [Technical data](#)

Menu

- [Hot foil stamping machines RF 82 and RF 90](#)
- [Hot foil stamping machines RF 106](#)
- [Hot foil stamping machines Foil-WEB RR 650, RR 850 and RR 1060](#)
- [Steuer Foil-Jet FBR 2020](#)
- [Foil modules KFM 76 and KFM 106](#)

Contact

spm steuer gmbh & co. kg
Ernst-Mey-Straße 7
D-70771 Leinfelden-
Echterdingen

Tel.: +49 (0)711 / 78 74 77-0
Fax: +49 (0)711 / 78 74 77-10
E-Mail: info@spmsteuer.com

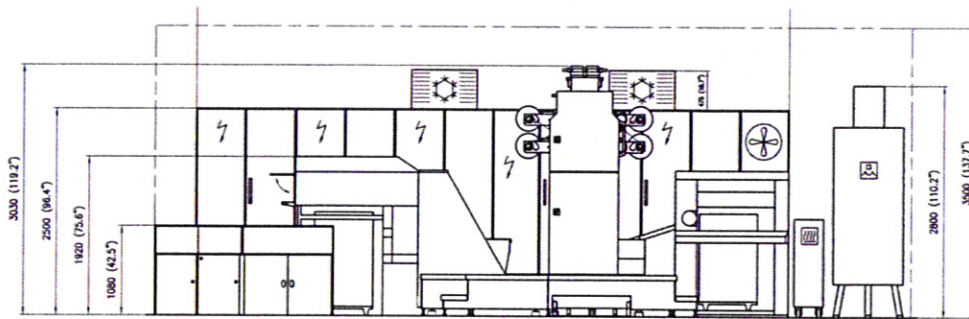

Designation	Foil-Jet FBR 104
Output per hour	up to 12,000 sheets
Sheet size max.	720 x 1,040 mm
Sheet size enlargement	740 x 1,050 mm
Sheet size min.	280 x 420 mm
Stamping size max.	710 x 1,020 mm
Stamping size max. for use of wrap-around plates	695 x 1,020 mm
Gripper edge	10 - 12 mm
Foil rolls, diameter max.	300 mm
Foil rolls, diameter optional	450 mm
Foil rolls, width max.	1,020 mm
Foil rolls, width min.	35 mm
Number of foil webs (max. 12)	4
Number of foil program controls (max. 6)	2
Pressure in stamping nip line max.	5 N/mm ²
Pile height delivery	1,045 mm
Nominal output	60 kW
Average power requirement	32 kW
Nominal voltage	3 x 400 V
Nominal frequency	50/60 Hz
Back-up fuses	3 x 160 A
Machine length	6,160 mm
Machine width	4,500 mm
Machine height	3,030 mm