

PREPRESS

PRESS

POSTPRESS

Stitchmaster ST 90



Technical Data

HEIDELBERG

Technical Data

Stitchmaster ST 90

Output	mechanical	max. 9,000 cycles/h min. 1,500 cycles/h
Formats	untrimmed	max. 12" x 14" (30.5 x 35.5 cm) min. 3 1/2" x 5" (9 x 13 cm)
	trimmed	max. 12" x 13 3/4" (30.5 x 34.9 cm) min. 3 1/2" x 4 3/4" (9 x 12.0 cm)
Product thickness		max. 3/8" (10 mm)
Stitching heads		max. up to 4 standard or loop stitching heads
Opening methods	Gripper opening	with low folio lip min. 3/16" (8 mm) with high folio lip min. 1/4" (6 mm)
	Vacuum opening	
Single hand feeder		187 lbs. (85 kg)
Double vertical feeder		860 lbs. (390 kg)
Cover folder feeder		706 lbs. (320 kg)
Stitcher		1,654 lbs. (750 kg)
Trimmer with infeed		3,351 lbs. (1,520 kg)
Conveyor table with batch marker		66 lbs. (30 kg)
Stream delivery		198 lbs. (90 kg)

Stitchmaster ST 90

The Heidelberg saddle stitcher Stitchmaster ST 90 is designed especially for small to medium print runs with frequent format changes. With an output capacity of up to 9,000 cycles/h and a format range up to 12" x 13 3/4" (30.5 cm x 34.9 cm) and the technical standard equipment make the Stitchmaster ST 90 the machine to launch into saddle stitching. Due to its compact design, this system requires a **minimum** of space. Make-readies are reduced to a **minimum**.

A menu driven setup program supports the operator in setting the machine. For format changes, the setting positions are approached step by step by the SPS control system and indicated in the digital display:

Menu-driven set up

- Face trim
- Head and tail trim
- Trimmer infeed
- Synchronization saddle chain/trimmer infeed
- Product thickness inspector

Stitcher

Standard with two stitching heads for 1/2" (13 mm) standard stitch. The stitching unit can accommodate up to four standard or loop stitch heads. The standard side mounted product thickness inspector (caliper) is situated between cover feed and stitching unit. Faulty or incomplete products are rejected unstitched.

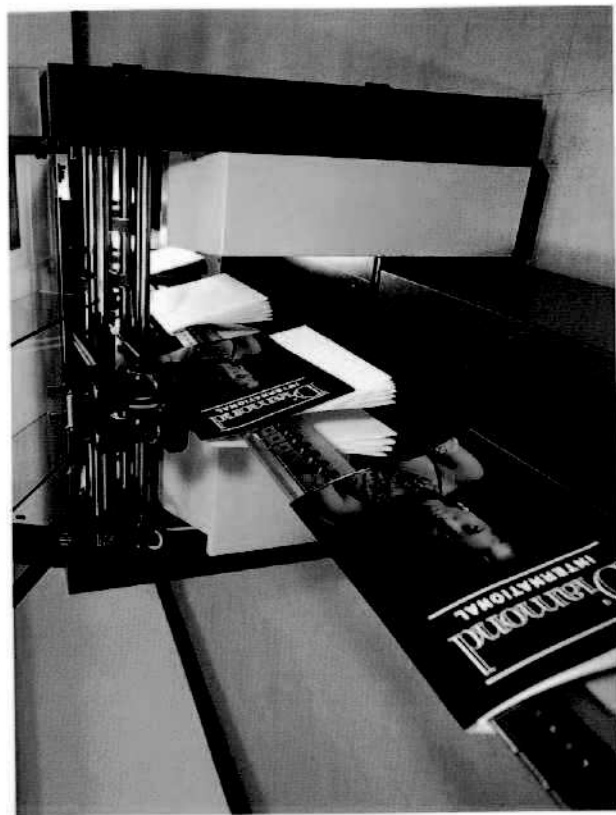

Trimmer

The trimmer is of a robust and solid construction. Product trimming is carried out with all transfer elements completely stationary. The trim sequence is fore-edge first, then head and tail simultaneously, to a maximum trim off width of up to 2" (50 mm) on all three sides. Optional center trimming attachments for the parting cut and the punch cut (gutter) are quick and easy to install.

Deliveries

The Stitchmaster ST 90 comes with a stream delivery with batching unit as standard. A compensating stacker for counted and crisscrossed stacks is available as an option. In addition any Heidelberg Finishing delivery system can be used.

Double Vertical Feeder

The modular design feeders process signatures with either vacuum or gripper opening. The Stitchmaster ST 90 can be extended to a total of 4 double vertical feeders (8 pockets) at any time. With a few simple adjustments the double vertical feeders can be connected or disconnected or run at half (1:2) or full (1:1) speed. Format changes are completed in a minimum of time. The signatures are stacked vertically, spine down, in an ergonomically favorable loading height. The large stack capacity means less loading. Moreover, vertical signatures cause less pressure on

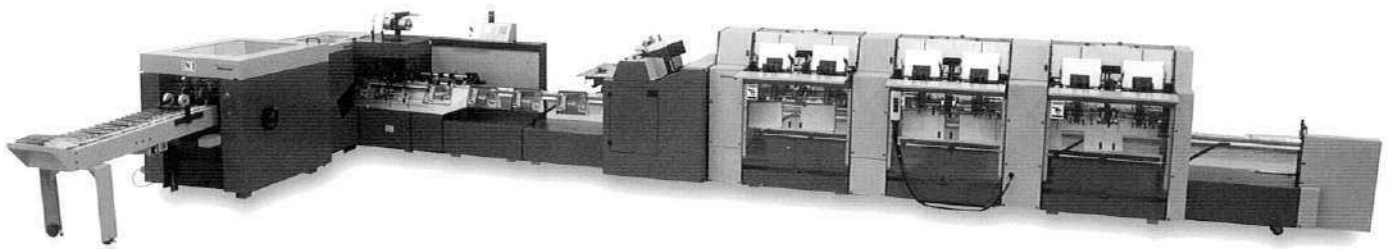

the pile and marking is largely avoided. The signature is fed neatly and reliably at the register, no setting operations are required. Signatures can be fed three ways; Vacuum Opening-Signatures with closed head or tail are reliably opened by suckers, High Folio Opening-Signatures with high folio lip (min. $\frac{1}{4}$ "/6 mm) are processed, Low Folio Opening-Signatures with low folio lip (min. $\frac{5}{16}$ "/8 mm) are processed.

Cover Folder Feeder

The Heidelberg Stitchmaster ST 90 cover folder feeder and the double vertical feeders are characterized by the same beneficial features. The gentle feed ensures the processing of vertical covers, and the pressure on the pile remains low despite the large feeder capacity. Format changes are carried out quick and easy. Micro adjustments of the fold position, the signature skew, and the suction and air supply can be carried out during the production run. Varying paper quality and cover grain direction can be processed perfectly with the inner and outer scoring attachment. Inner and outer scoring can be used alternatively and change over requires a few simple adjustments only. The Stitchmaster ST 90 cover folder feeder is designed especially for the high production safety provided by a professional saddle stitcher in the A4 ($8\frac{1}{2}$ " x 11") format range.

Hand Feed Station

Single or double hand feed stations are available as an option.

Highlights

Output max. 9,000 cycles/h

Product thickness max. $\frac{3}{8}$ " (10 mm)

Up to four double vertical feeders

Vacuum or gripper opening

Vertical sheet feeding

Large stacking volume

Quick change over

Solid construction

Options

Center cut attachments for the parting cut and the punch cut

Hand feed station

Chip blowing system

Rima compensating stacker

Heidelberg Finishing delivery systems

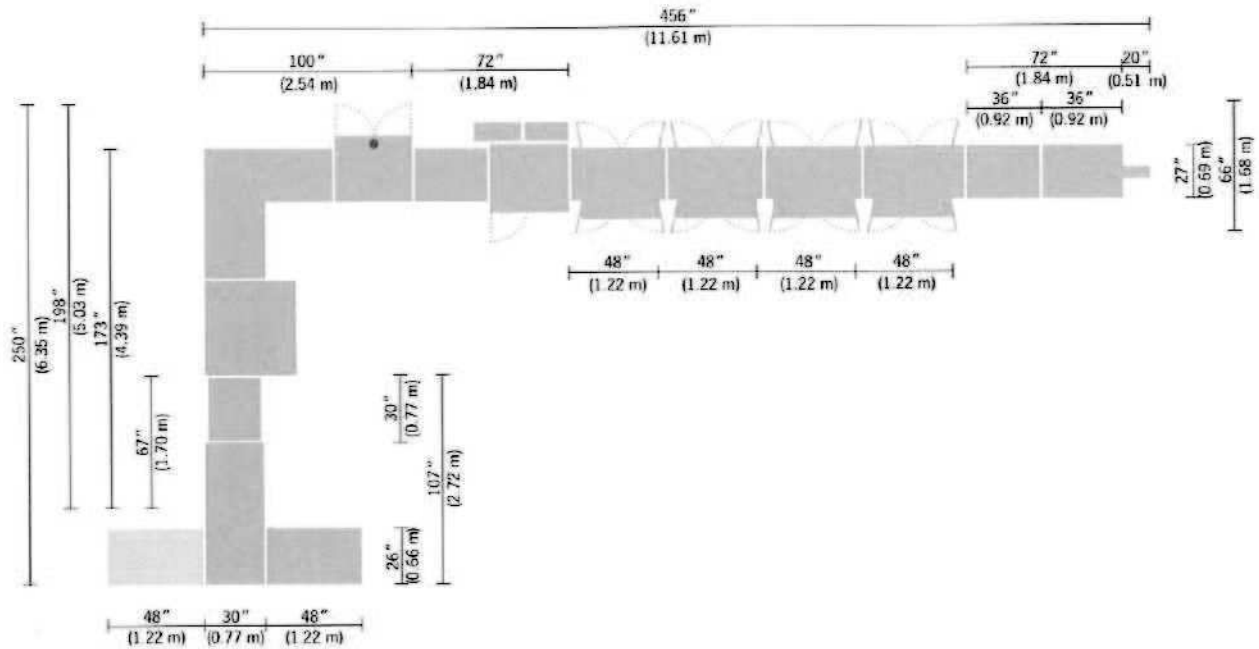

• Electrical connection

Not to scale

Dimension inches
(metric)

Measurements were transferred from metrics to inches and rounded off.

All contents subject to change without notice.

Vacuum Opening

Signatures with closed head or tail are reliably opened by suckers.

High Folio Opening

Signatures with high folio lip (min. 1/4"/6 mm) are processed.

Low Folio Opening

Signatures with low folio lip (min. 5/16"/8 mm) are processed.

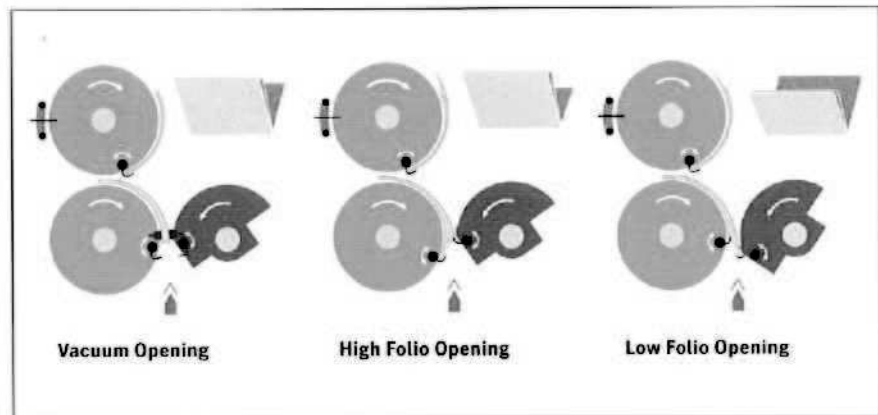

Heidelberg Druckmaschinen AG

Kurfuersten-Anlage 52-60

69115 Heidelberg

Germany

Phone +49-62 21-92-00

Fax +49-62 21-92-69 99

www.heidelberg.com

Presented by: